

# Standard Data Logger GMP TH F

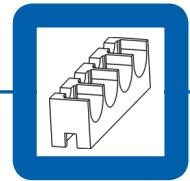

## Temperature and Humidity Data Logger with Flexible Sensor

0% to 100% RH  
-40°C to +100°C

- + Collects and stores humidity and temperature information in the internal memory
- + Recover the data through the docking station using XpertLog Software
- + ITS-90 calibration coefficients are stored in the internal memory
- + Complies with FDA 21 CFR Part 11
- + Network ready: multiple users, centralized, server database, active directory authentication

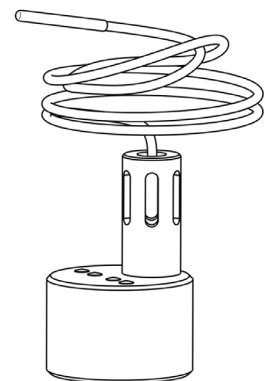
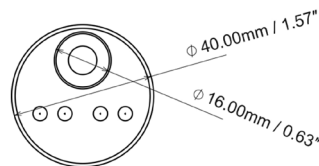
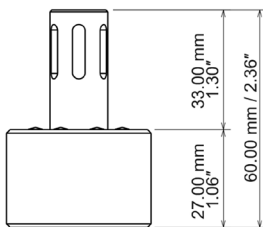

Sensor type  
- flexible  
- customized  
- Sensor size  
- cross section  
Operating Range  
- body

Hum: capacitive / Temp: 4 wires PT-100  
430 mm (17")  
up to 5000 mm (195")  
1.5 x 8 mm (0.06 x 0.315")  
1.77 mm<sup>2</sup> (0.0027 inch<sup>2</sup>)

- Sensor  
Accuracy

0% to 100% RH  
-40°C to +100°C  
-200°C to +200°C  
±2.0% RH, 0% to 75% non condensing at 20°C to 45°C  
±3.0% RH, 75% to 100% non condensing at 20°C to 45°C  
±0.1°C from -40°C to +100°C

Resolution  
Memory capacity  
Memory type  
Sampling rate  
Internal clock drift

0.01% RH; 0.01°C  
16,000 data points humidity / 16,000 data points temperature  
non volatile  
1 sec to 24 hours  
4 sec / 24 h @ 23°C

Mechanical  
- material  
- enclosure  
- weight  
- diameter  
- height

Peek 1000 - FDA compliant  
IP-51  
43 g (1.52 oz)  
40,0 mm (1.57")  
60,0 mm (2.36")

Power

1 x Lithium batteries, 0.35 g/each Lithium content  
classified UN3091 under IATA DGR section 3.9.2.6  
compliant with ICAO/IATA packing instructions 970, user replaceable

Battery lifetime  
Docking station

Up to 12 months, based on usage  
USB to computer  
4, 8, 12 and 20 ports available

Calibrations

Programs and reads unlimited number of loggers  
Factory Calibrations: traceable NIST/COFRAC - ITS-90 coefficients stored in the internal memory

Certification

User Calibrations: closed loop calibration using XpertLog® software  
Health Safety: EN 60950-1 / 2006  
EMC: EN 60601-1-2 / 2007

Order Reference  
GMP-TH-F

### Standard Calibration Points

- 25°C / 20% RH
- 25°C / 45% RH
- 30°C / 65% RH
- 40°C / 75% RH

Upon special request:

- 45°C / 90% RH



XpertLog  
software

