

Real Time Wireless Temperature and Humidity Data Logger with Rigid Sensor

0% to 100% RH non condensing
-40°C to +100°C

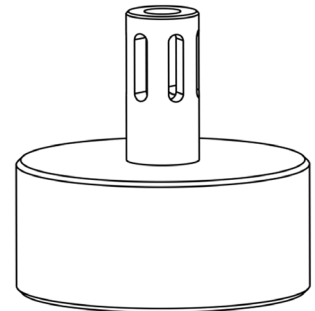

- + Collects and transmits real time humidity and temperature to XpertLog Software
- + ITS-90 calibration coefficients are stored in the internal memory
- + Complies with FDA 21 CFR Part 11
- + Network ready: multiple users, centralized, server database, active directory authentication
- + Can be remotely activated

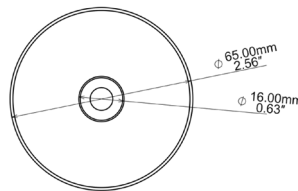
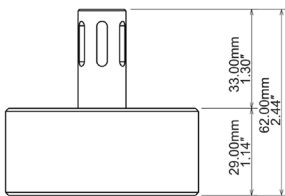

Sensor type	Hum: capacitive / Temp: 4 wires PT-100
- rigid	20 mm (0.8")
- customized	available
- Sensor size	1.5 x 8 mm (0.06 x 0.315")
- cross section	1.77 mm ² (0.0027 inch ²)
Operating Range	
- body	0% to 100% RH non condensing
	-40°C to +100°C
- Sensor	-40°C to +100°C
Accuracy	±2.0% RH, 0% to 75% non condensing at 20°C to 45°C
	±3.0% RH, 75% to 100% non condensing at 20°C to 45°C
	±0.1°C from -40°C to +100°C
Resolution	0.01% RH; 0.01°C
Memory capacity	16,000 data points humidity / 16,000 data points temperature
Memory type	non volatile
Sampling rate	1 sec to 24 hours
Transmission	simultaneous: maximum 20 loggers
	sequential: unlimited
Internal clock drift	4 sec / 24 h @ 23°C
Mechanical	
- material	Peek 1000 - FDA compliant
- enclosure	IP-51
- weight	95 g (3.35 oz)
- diameter	65 mm (2.56")
- height	62 mm (2.44")
Power	2 x Lithium batteries, 0.35 g/each Lithium content classified UN3091 under IATA DGR section 3.9.2.6 compliant with ICAO/IATA packing instructions 970, user replaceable
Battery lifetime	Up to 6 months, based on usage
Antenna	Internal
Wireless range	121 m (400 feet)
Radio frequency	2.4 Ghz ISM band
Access point	USB to computer
Calibrations	Programs and reads unlimited number of loggers
	Factory Calibrations: traceable NIST/COFRAC - ITS-90 coefficients stored in the internal memory
	User Calibrations: closed loop calibration using XpertLog® software
Certification	Health Safety: EN 60950-1 / 2006
	EMC: EN 60601-1-2 / 2007
	RF: EN 300440-2 v1.3.1 (2009-03)

Order Reference
GMP-RF-TH

Standard Calibration Points

- 25°C / 20% RH
- 25°C / 45% RH
- 30°C / 65% RH
- 40°C / 75% RH

Upon special request:
• 45°C / 90% RH

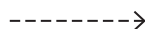

XpertLog
software

