

## Real Time Wireless Temperature and Humidity Data Logger with Rigid Sensor

15% to 95% RH

-40°C to +85°C



- + Collects and stores humidity and temperature information in the internal memory
- + Recover the data through the docking station using XpertLog Software
- + ITS-90 calibration coefficients are stored in the internal memory
- + Complies with FDA 21 CFR Part 11
- + Network ready: multiple users, centralized, server database, active directory authentication

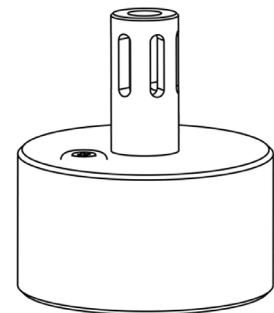
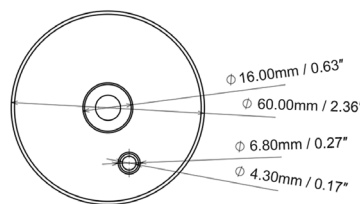
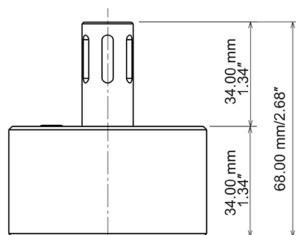

Sensor type  
- rigid

Hum: capacitive / Temp: 4 wires PT-100  
20 mm (0.8")

- Sensor size  
- cross section  
Operating Range  
- body

1.5 x 8 mm (0.06 x 0.315")  
1.77 mm² (0.0027 inch²)

- Sensor  
Accuracy

15% to 95% RH  
-40°C to +85°C  
-40°C to +85°C  
±2.0% RH @ +23°C (15% - 60% RH)  
±3.0% RH @ +23°C (60% - 95% RH)  
±0.1°C from -40°C to +85°C

Resolution  
Memory capacity  
Memory type  
Sampling rate  
Transmission

0.01% RH; 0.01°C  
16,000 data points humidity / 16,000 data points temperature  
non volatile  
1 sec to 24 hours  
simultaneous: maximum 20 loggers  
sequential: unlimited  
4 sec / 24 h @ 23°C

Internal clock drift  
Mechanical

Peek 1000 - FDA compliant  
IP-51  
93 g (3.28 oz)  
60.0 mm (2.36")  
68.0 mm (2.68")

- material  
- enclosure  
- weight  
- diameter  
- height

Power

External and internal, 2 x Lithium batteries, 0.35 g/each Lithium content  
classified UN3091 under IATA DGR section 3.9.2.6  
compliant with ICAO/IATA packing instructions 970, user replaceable  
Up to 6 months, based on usage

Battery lifetime

Antenna

Wireless range

Radio frequency

Access point

2.4 Ghz ISM band  
USB to computer  
Programs and reads unlimited number of loggers  
Factory Calibrations: traceable NIST/COFRAC - ITS-90 coefficients stored in the internal memory

Calibrations

Certification

User Calibrations: closed loop calibration using XpertLog® software  
Health Safety: EN 60950-1 / 2006  
EMC: EN 60601-1-2 / 2007  
RF: EN 300440-2 v1.3.1 (2009-03)

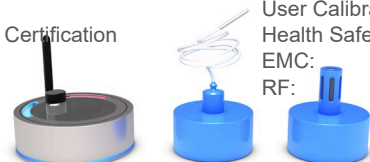

XpertLog  
software



Order Reference

LMS-TH

Standard Calibration Points

- 25°C / 20% RH
- 25°C / 45% RH
- 30°C / 65% RH
- 40°C / 75% RH

Upon special request:

- 45°C / 90% RH